

Stored  
pressure

Water

6 L

Temperature ranges

0°C + 60°C



34

### BODY

ALUMINUM

Seamless, deep drawn aluminum alloy body, ensures maximum sealing and, thanks to its light weight, perfect handling. Externally painted with polyester resin

### VALVE

ALUMINUM

Squeeze grip lever operated valve with aluminum body. The shock-proof pressure gauge provides an accurate indication of the pressure status of the extinguisher

### HOSE

The EPDM reinforced rubber hose guarantees perfect flexibility and resistance within the temperature range. Complete with nozzle

### EXTINGUISHING AGENT

Water-based agent (Sorik Li), designed to significantly reduce surface tension and droplet size, ensuring a high cooling effect. Fluorine-free, thus fully biodegradable

### PROPELLANT

The propellant gas is nitrogen. A small percentage of helium is added to allow electronic leak detection

### STANDARD PACKAGING

Single piece cardboard box, robust and suitable for transport



WEIGHT Kg	8,50
DIMENSION mm	160 Ø x 550

### Accessories

● Standard ○ On request

### BRACKET

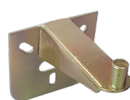

● Button holed wall bracket ○ Back hook wall bracket kit ○ Transport bracket

### HOSE RINGS & PROTECTIVE BASE



● Green protective base 160 mm ○ Protective base 160 mm ○ Hose holder 160mm

### ADDITIONAL FEATURES



● One color screen printing ○ Two-color PVC label ○ Safety Valve LHZ

### PACKAGING



● One-piece havana cardboard box ○ One-piece colored cardboard box

# Technical data

FIRE RATINGS	34A	
CHARGE	6 l +0 / -5%	
CYLINDER	Manufacturing process	Deep drawn
	External painting	Polyester resin, minimum thickness 75 micron
	Corrosion resistance	480 h minimum according to ISO 9227:1990
HOSE	Reinforced rubber tube with nozzle	
	Overall length	565 mm
EXTINGUISHING AGENT	ANAF - SORIK Li	
PROPELLANT	Nitrogen or nitrogen + helium	
DISCHARGE	Discharge time	~ 38 s
PRESSURE	Operating pressure at 20 °C	11 bar
	Operating pressure at 60 °C	13 bar
	Operating pressure at 0 °C	9 bar
DIMENSIONS	Overall height	550 mm
	Bottle outer diameter	160 mm
WEIGHT	Empty / Charged	1,8 kg / 8,5 kg
PACKING SPECIFICATIONS	Standard packing	Single piece cardboard box
	Carton size (B x L x H)	180 x 175 x 590 mm
	Weight per carton	8,8 kg
	Pallet	81 cartons
	Pallet size (B x L x H)	800 x 1200 x 1670 mm
	Pallet volume	1,60 m <sup>3</sup>
	Weight per pallet (net/gross)	713 kg / 733 kg

© REPRODUCTION IS FORBIDDEN

87.486E.01.05.2021

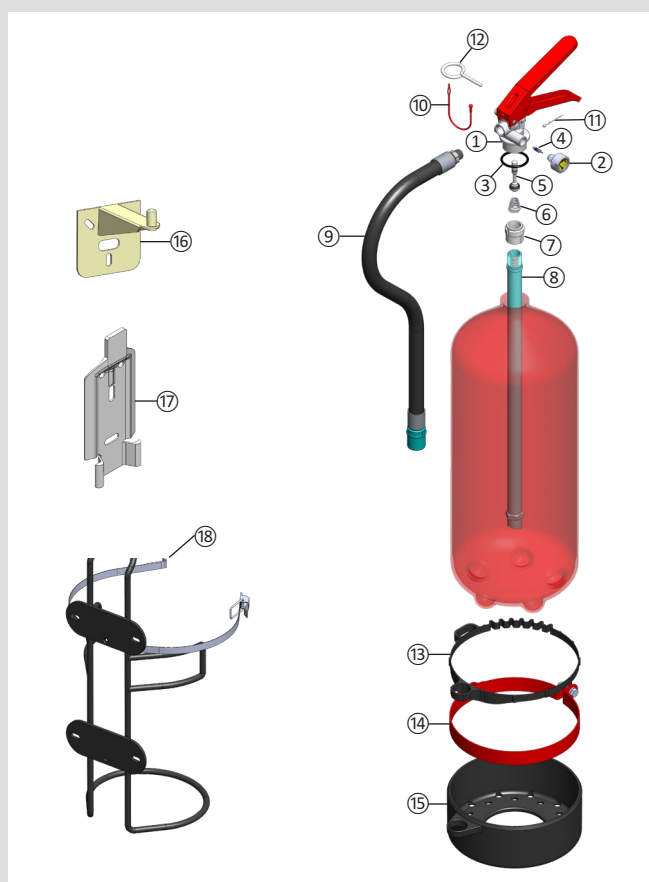

Nr.	Description	Code
1	Complete valve without pressure gauge	00.886E.8090.00
2	Pressure gauge	00.814E.4950.20
3	O-ring for the valve	00.033E.1100.01
4	Check valve type Schrader	00.886E.5100.00
5	Internal spindle with o-ring	00.886E.5030.00
6	Conical spring	00.886E.5200.00
7	Dip tube holder	00.886E.5810.00
8	Dip tube	00.886E.5900.00
9	Assembled hose	00.860E.2400.25
10	Red lace holder for safety pin	00.886E.6290.00
11	Safety seal	00.245E.5030.00
12	Metal safety pin	00.886E.5020.00
13	Hose holder Ø160	00.241E.2800.00
14	Metallic support Ø160	00.850E.2970.00
15	Plastic base Ø160 with hose holder	00.850E.7100.01
16	Button holed wall bracket	00.005E.2900.00
17	Hook wall bracket	00.005E.2950.00
18	Transport bracket Ø160	00.241E.2900.00

## ANAFGROUP

Via del Commercio, 4 - Torre d'Isola (Pavia)  
 Tel. 0382.4533 Fax. 0382.920279  
 info@anaf.eu | www.anaf.eu